

## **INSTALLATION OF PEPSI BOTTOM DOOR LOCK HASP KIT M038.1**

**Bottom Door Lock Hasp Kit Order:**

1 - 592,050,00x.x4      Bottom Door Lock Hasp Kit

**Kit Contents:**

1 - 592,051,16x.x3	Hasp Bracket
1 - 801,305,64x.x1	Steel Hasp
1 - 592,051,17x.x3	Latch Hasp
1 - 900,801,02x.x1	Hex Nut, 5/16-18
1 - 800,303,20x.x1	Hex Bolt 5/16-18x3
6 - 900,201,56x.x1	Carriage Bolt 14-20x3/4
6 - 900,800,67x.x1	Keps Nut 1/420
1 - 900,301,55x.x1	Screw, #8-32x1/2

**BOTTOM DOOR LOCK HASP INSTALLATION:**

1. Open the main door.
2. Assemble the hasp bracket (A, Figure 1) and the steel hasp (B, figure 1) using the 5/16-18 hex bolt (D, figure 1). **DO NOT INSTALL HEX NUT AT THIS TIME.**
3. Place the assembly on the base of the vender next to the door roller as shown in figure 2. Ensure there is no interference with the roller and that there is enough clearance on the right side (near the cabinet flange) to install the hex nut. Make sure the bottom of the bracket rests on the base plate.
4. Hold the assembly in position, use the two square holes in the bracket as a template and mark the holes.
5. Remove the assembly and take it apart.
6. Remove the bracket and drill the two square holes with a 1/4 " drill bit.
7. Remove the cabinet front stiffener plate.
8. Secure the bracket using two carriage bolts and nuts.
9. Using a 9/32" drill bit, drill a small hole in the base of the vender using the small circular hole in the bracket as a template.
10. Secure with #8-32x1½ screw supplied in the kit.
11. Install the cabinet front stiffener plate removed in step 7.
12. Assemble the steel hasp to the hasp bracket and secure with 5/16-18 hex bolt and nut.
13. Lay the steel hasp in horizontal position and close the door.
14. Place the latch hasp on front of the vender so the large round hole in it and in the steel hasp on the bracket assembly align. See figure 3.
15. Use the latch hasp as a template and mark the four square mounting holes.
16. Remove the bracket and drill the four square holes with a 1/4" drill bit.
17. Secure the bracket using four carriage bolts and nuts.
18. Install a lock to secure. Use American Lock Company Series 2000 Lock or one similar. See figure 4.

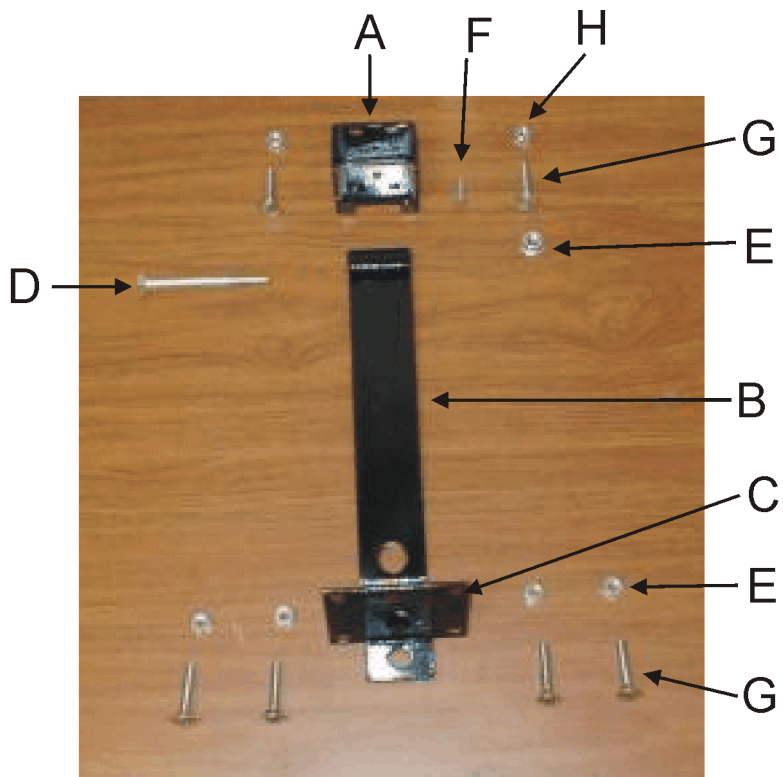

Figure 1



Figure 2



Figure 3

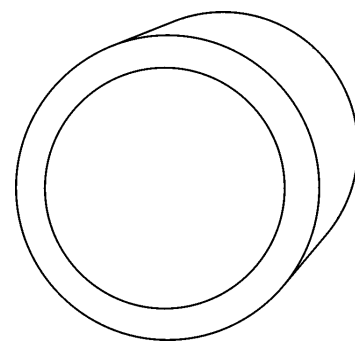

Figure 4